

The National Academies of
SCIENCES • ENGINEERING • MEDICINE

DIVISION ON ENGINEERING AND PHYSICAL SCIENCES
SPACE STUDIES BOARD

Committee to Review the NASA Science Mission Directorate Science Plan

1-2 August, 2019

NAS Building | 2101 Constitution Ave NW, Washington D.C. | Board Room

DRAFT AGENDA

Thursday, 1 August, 2019

Board Room
2101 Constitution Ave. NW

National Academy of Sciences
Washington, D.C. 20418

OPEN SESSION

Zoom Remote Access Information – Day 1 Open
Link: <https://nasem.zoom.us/j/150984773>

Phone: (646) 558-8656 or (669) 900-6833
Meeting ID: 150984773

- 7:30 a.m. Meeting room opens, *working breakfast available in the meeting room*
- 8:00 a.m. Welcome Jeff Dozier
- 8:01 a.m. Introduction to NASA Science Plan Thomas Zurbuchen
NASA Headquarters
- 8:45 a.m. Context for NASA Science Plan Ellen Gertsen/Michael New
NASA Headquarters
- 9:45 a.m. *Break*
- 10:00 a.m. NASA Advisory Council Assessment of the NASA Science Plan Meenakshi Wadhwa/Elaine Denning
Arizona State University/NASA Headquarters
- 11:00 a.m. General Discussion Committee and Guests
- 11:30 a.m. *Working lunch will be served in the meeting room*

CLOSED SESSION

- 12:30 p.m. Closed Session
- 5:30 p.m. Adjourn for dinner

OPEN SESSION

- 6:30 p.m. Working dinner to discuss presentations: La Chaumiere
2813 M St NW | 202-638-0800
- 8:00 p.m. Adjourn for the day

Friday, 1 August, 2019

Board Room
2101 Constitution Ave. NW

National Academy of Sciences
Washington, D.C. 20418

OPEN SESSION

Zoom Remote Access Information – Day 1 Open
Link: <https://nasm.zoom.us/j/829679517>

Phone: (646) 558-8656 or (669) 900-6833
Meeting ID: 829679517

7:30 a.m. Meeting room opens, *working breakfast available in the meeting room*

9:00 a.m. Additional Discussion with NASA (if required, otherwise closed session) Ellen Gertsen/Michael New
NASA Headquarters

10:00 a.m. *Break*

CLOSED SESSION

10:15 a.m. Closed Session

3:00 p.m. Meeting Adjourns

STATEMENT OF TASK

The National Academies of Sciences, Engineering, and Medicine will convene an ad hoc committee to conduct an assessment of NASA's Science Mission Directorate (SMD) draft Science Plan and issue a report addressing the following issues:

1. Level of ambition of the specified strategies in light of current and emerging opportunities to advance Earth and space science over the next 5 years;
2. Ability of SMD to meet the science objectives in the most recent decadal surveys through implementation of specified strategies;
3. Identification of additional strategies for SMD's consideration; and
4. General readability and clarity of presentation.

NOTES

Note to Presenters: If your presentation contains unpublished data, ITAR controlled and/or other sensitive information, please be aware that the open sessions at the meeting may be webcast and presentation materials given to the committee may be posted on a publicly accessible website. Please edit your presentations accordingly.

Note to Observers: This meeting is being held to gather information to help the committee conduct its activities. The committee will examine the information and material obtained during open sessions in an effort to inform its work. Although opinions may be stated and lively discussion may ensue, no conclusions are being drawn at this time. Therefore, observers who draw conclusions about the committee's work based on discussions during this meeting will be doing so prematurely. Furthermore, individual committee members often engage in discussion and questioning for the specific purpose of probing an issue and sharpening an argument. The comments of any given committee member may not necessarily reflect the position he or she may actually hold on the subject under discussion, to say nothing of that person's future position as it may evolve in the course of the committee's activities.

NAS Building: Is located at 2101 Constitution Ave., NW, between the State Department and the Vietnam Veterans Memorial. The building may be accessed via entrances on Constitution Ave. or C Street (across the street from the State Department). Additional information about the NAS Building is available at <http://www.nas.edu/about/contact/index.html>.

Metro: The closest Metro station (0.5 miles) is Foggy Bottom (Blue, Orange and Silver lines; exit and turn right onto 23rd St., then turn left onto C St. once you have passed the State Department. Information about the D.C. Metro can be found at <http://www.wmata.com/>.

Parking: Very limited parking is available onsite at the NAS. The 22 available parking spaces are first come first served. Other available parking options are as follows:

- PMI (Columbia Plaza)—2400 Virginia Avenue NW. Phone (202) 785-2448. The daily rate is \$24.
- PMI—111 19th Street NW. Phone (202) 466-7557. The daily rate is \$16.
- Colonial Parking—2100 Pennsylvania Avenue NW. Phone (202) 295-8100. The daily rate is \$17.00.
- GW Elliot School Garage is located near the Department of Interior at 1957 E Street NW. The daily rate is \$26.00.

Hotel: A block of rooms for the use of committee members and guests has been reserved at the Watergate Hotel, 2650 Virginia Avenue NW. Please contact Andrea Rebholz at arebholz@nas.edu to reserve a room. The hotel telephone number is 202-827-1600. Additional hotel information can be found at: <https://www.thewatergatehotel.com/hotel>. The hotel is 0.7 mile from the NAS building.

Working Dinner: There will be a working dinner at La Chaumiere, near the corner of M Street and 28th Street (0.5 miles beyond Watergate Hotel). The telephone number for the restaurant is (202) 338-1784. More information can be found at: www.lachaumieredc.com. All meeting participants can attend if space is available. The Space Studies Board will only pay for members of the committee and guest speakers. Unfortunately, we cannot pay for federal employees and members of the public—for those attendees, the cost of the dinner is \$50.00. Checks, payable to the National Academy of Sciences, are preferred.

2012 NAS BUILDING

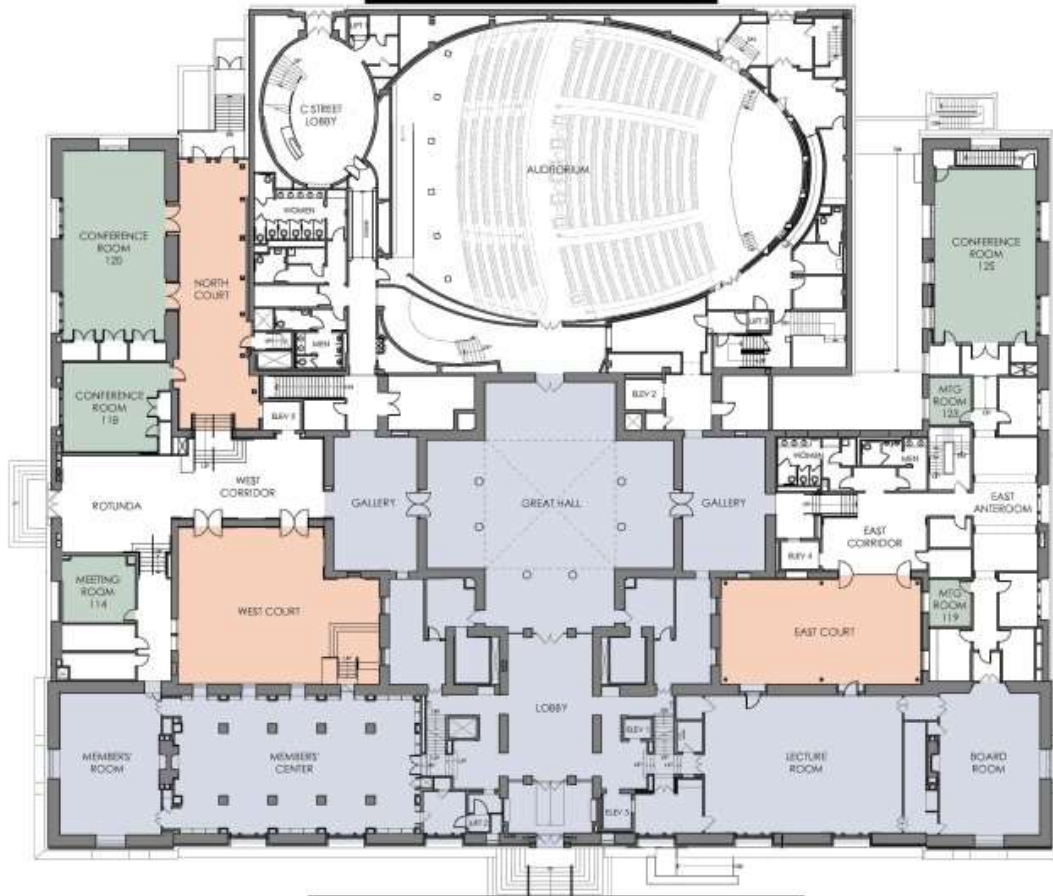

NEW FIRST FLOOR LAYOUT